

GSA100 – Bushing-type Current Transformer

The GSA100 is a cast-resin insulated bushing-type current transformer for indoor applications. They are suitable to put on cables or bus-bars. In case of higher voltage levels the primary conductor must be insulated according to the rated insulation levels. The cast resin insulated indoor bushing-type current transformer can be used up to 1,2 kV. The current transformer is maintenance-free and mountable in any position.

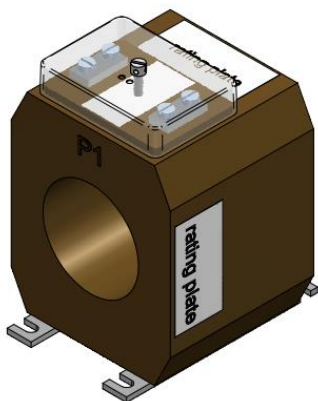

Ordering Specifications

For the customized design of your ELEQ GSA100 Current Transformer the following information is required:

Mandatory

- Rated primary current
- Rated secondary current
- Rated output
- Accuracy class
- Frequency

Optional

- Multi-core transformers are possible
- Terminal box sealable
- Other relevant requirements

Wiring diagram IEC 61869-2 e.g. single core

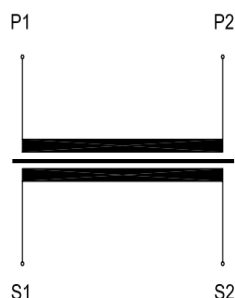

Technical specifications

| | |
|---|--|
| Environmental conditions | |
| This product is designed to be safe under the following conditions: | |
| Location: | Indoor use |
| Ambient air temperature: | -5°C .. +40°C; other temperatures on request |
| Storage and transport temperature: | -25°C .. +50°C |
| Relative humidity: | 5% .. 95%, non condensing |
| Altitude: | Max. 1000m above NN; at >1000m data required |
| Protection degree (secondary terminal): | IP20 |
| Application conditions | |
| Standard: | IEC 61869-2/IEEE C 57.13; etc. |
| IEC 61768-2 specification: | |
| Rated short-time thermal current (I _{th}): | 100 x I _n /1s, max. 100kA/1s, other duration on request |
| Rated dynamic current (I _{dyn}): | 2,5 x I _{th} |
| Continuous thermal current (I _{cth}): | up to 200% |
| Rated insulation level: | 1,2/6/-kV |
| Rated frequency: | 50/60Hz |
| Class of insulation: | E |
| Rated primary current: | 30A - 1000A |
| Rated secondary current: | 1A or 5A; other options available on request |
| Rated output: | As required. For example 10VA, 15VA |
| Accuracy class: | As required. For example 0,2, 5P20 |
| Secondary terminal: | Screw terminals M5 (max. 2,5Nm) |

Dimensions

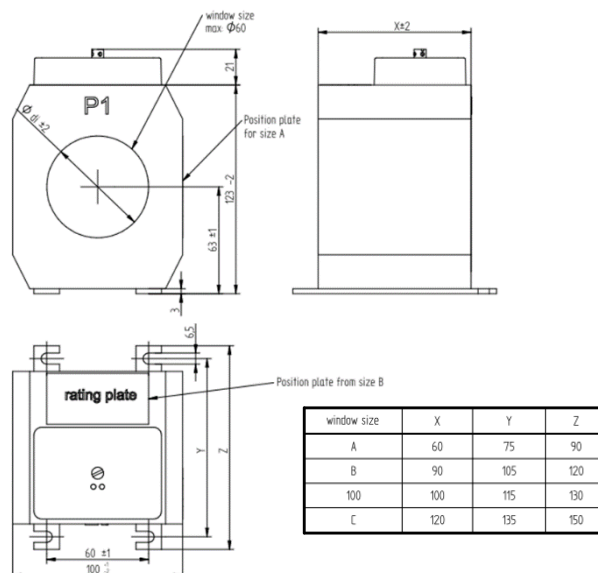

GSA105 – Bushing-type Current Transformer

The GSA105 is a cast-resin insulated bushing-type current transformer for indoor applications. They are suitable to put on cables or bus-bars. In case of higher voltage levels the primary conductor must be insulated according to the rated insulation levels. The cast resin insulated indoor bushing-type current transformer can be used up to 1,2 kV. The current transformer is maintenance-free and mountable in any position.



Ordering Specifications

For the customized design of your ELEQ GSA105 Current Transformer the following information is required:

Mandatory

- Rated primary current
- Rated secondary current
- Rated output
- Accuracy class
- Frequency

Optional

- Multi-core transformers are possible
- Terminal box is sealable
- Other relevant requirements

Wiring diagram IEC 61869-2 e.g. single core

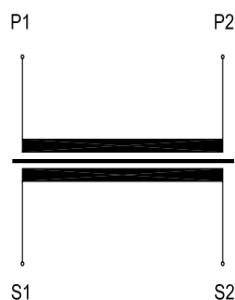

Technical specifications

| | |
|---|---|
| Environmental conditions | |
| This product is designed to be safe under the following conditions: | |
| Location: | Indoor use |
| Ambient air temperature: | -5°C .. +40°C; other temperatures on request |
| Storage and transport temperature: | -25°C .. +50°C |
| Relative humidity: | 5% .. 95%, non condensing |
| Altitude: | Max. 1000m above NN; at >1000m data required |
| Protection degree (secondary terminal): | IP20 |
| Application conditions | |
| Standard: | IEC 61869-2/IEEE C 57.13; etc. |
| IEC 61768-2 specification: | |
| Rated short-time thermal current (I _{th}): | 100 x I _n /1s, max. 60kA/1s, other duration on request |
| Rated dynamic current (I _{dyn}): | 2,5 x I _{th} |
| Continuous thermal current (I _{cth}): | up to 200% |
| Rated insulation level: | 1,2/6/-kV |
| Rated frequency: | 50/60Hz |
| Class of insulation: | E |
| Rated primary current: | 30A - 600A |
| Rated secondary current: | 1A or 5A; other options available on request |
| Rated output: | As required. For example 10VA, 15VA |
| Accuracy class: | As required. For example 0,2, 5P20 |
| Secondary terminal: | Screw terminals M5 (max. 2,5Nm) |

Dimensions

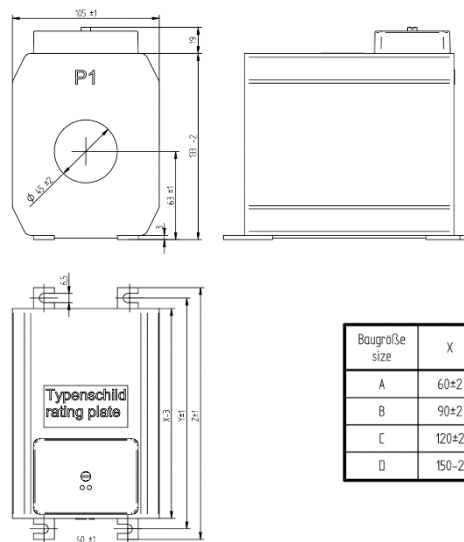

| Baugröße | X | Y±1 | Z±1 |
|----------|-------|-----|-----|
| A | 60±2 | 75 | 90 |
| B | 90±2 | 105 | 120 |
| C | 120±2 | 135 | 150 |
| D | 150±2 | 165 | 180 |



GSA110 – Bushing-type Current Transformer

The GSA110 is a cast-resin insulated bushing-type current transformer for indoor applications. They are suitable to put on cables or bus-bars. In case of higher voltage levels the primary conductor must be insulated according to the rated insulation levels. The cast resin insulated indoor bushing-type current transformer can be used up to 1,2 kV. The current transformer is maintenance-free and mountable in any position.

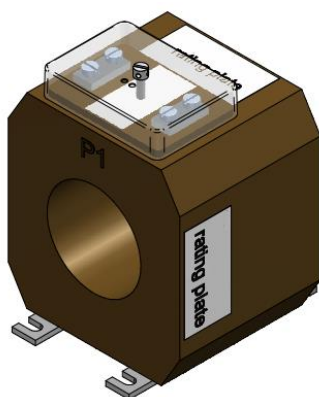

Ordering Specifications

For the customized design of your ELEQ GSA110 Current Transformer the following information is required:

Mandatory

- Rated primary current
- Rated secondary current
- Rated output
- Accuracy class
- Frequency

Optional

- Multi-core transformers are possible
- Terminal box sealable
- Other relevant requirements

Wiring diagram IEC 61869-2 e.g. single core

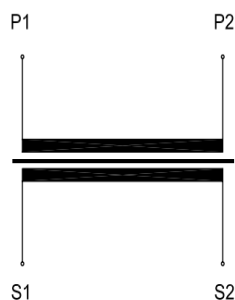

Technical specifications

| | |
|---|--|
| Environmental conditions | |
| This product is designed to be safe under the following conditions: | |
| Location: | Indoor use |
| Ambient air temperature: | -5°C .. +40°C; other temperatures on request |
| Storage and transport temperature: | -25°C .. +50°C |
| Relative humidity: | 5% .. 95%, non condensing |
| Altitude: | Max. 1000m above NN; at >1000m data required |
| Protection degree (secondary terminal): | IP20 |
| Application conditions | |
| Standard: | IEC 61869-2/IEEE C 57.13; etc. |
| IEC 61768-2 specification: | |
| Rated short-time thermal current (I _{th}): | 100 x I _n /1s, max. 100kA/1s, other duration on request |
| Rated dynamic current (I _{dyn}): | 2,5 x I _{th} |
| Continuous thermal current (I _{cth}): | up to 200% |
| Rated insulation level: | 1,2/6-kV |
| Rated frequency: | 50/60Hz |
| Class of insulation: | E |
| Rated primary current: | 30A - 1000A |
| Rated secondary current: | 1A or 5A; other options available on request |
| Rated output: | As required. For example 10VA, 15VA |
| Accuracy class: | As required. For example 0,2, 5P20 |
| Secondary terminal: | Screw terminals M5 (max. 2,5Nm) |

Dimensions

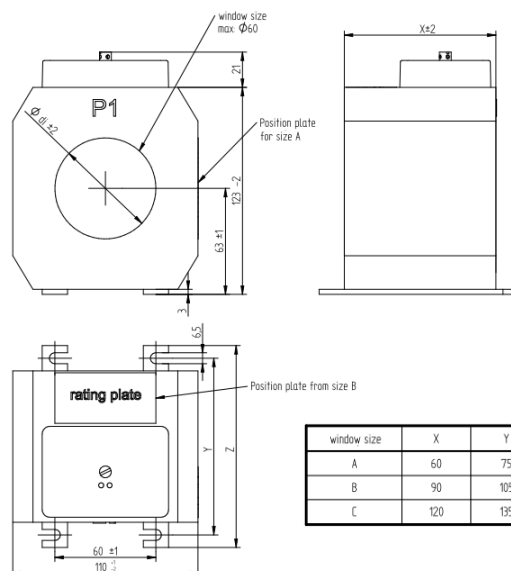

GSA120 – Bushing-type Current Transformer

The GSA120 is a cast-resin insulated bushing-type current transformer for indoor applications. They are suitable to put on cables or bus-bars. In case of higher voltage levels the primary conductor must be insulated according to the rated insulation levels. The cast resin insulated indoor bushing-type current transformer can be used up to 1,2 kV. The current transformer is maintenance-free and mountable in any position.

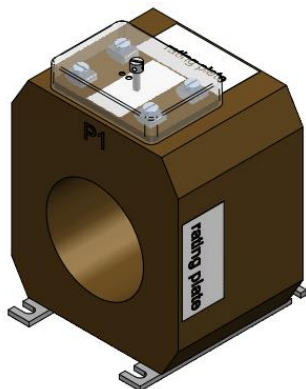

Ordering Specifications

For the customized design of your ELEQ GSA120 Current Transformer the following information is required:

Mandatory

- Rated primary current
- Rated secondary current
- Rated output
- Accuracy class
- Frequency

Optional

- Multi-core transformers are possible
- Terminal box sealable
- Other relevant requirements

Wiring diagram IEC 61869-2 e.g. single core

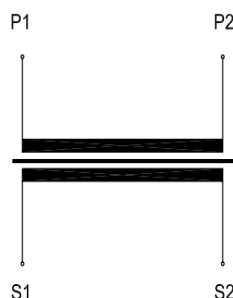

Technical specifications

| | |
|---|--|
| Environmental conditions | |
| This product is designed to be safe under the following conditions: | |
| Location: | Indoor use |
| Ambient air temperature: | -5°C .. +40°C; other temperatures on request |
| Storage and transport temperature: | -25°C .. +50°C |
| Relative humidity: | 5% .. 95%, non condensing |
| Altitude: | Max. 1000m above NN; at >1000m data required |
| Protection degree (secondary terminal): | IP20 |
| Application conditions | |
| Standard: | IEC 61869-2/IEEE C 57.13; etc. |
| IEC 61768-2 specification: | |
| Rated short-time thermal current (I _{th}): | 100 x I _n /1s, max. 100kA/1s, other duration on request |
| Rated dynamic current (I _{dyn}): | 2,5 x I _{th} |
| Continuous thermal current (I _{cth}): | up to 200% |
| Rated insulation level: | 1,2/6-kV |
| Rated frequency: | 50/60Hz |
| Class of insulation: | E |
| Rated primary current: | 30A - 1250A |
| Rated secondary current: | 1A or 5A; other options available on request |
| Rated output: | As required. For example 10VA, 15VA |
| Accuracy class: | As required. For example 0,2, 5P20 |
| Secondary terminal: | Screw terminals M5 (max. 2,5Nm) |

Dimensions

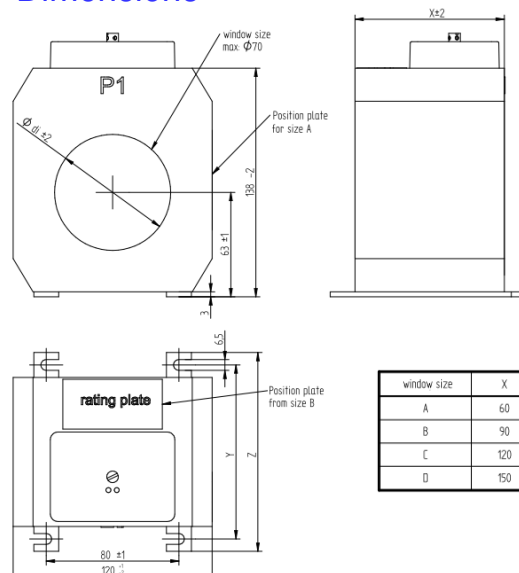

Ref. 1



GSA130 – Bushing-type Current Transformer

The GSA130 is a cast-resin insulated bushing-type current transformer for indoor applications. They are suitable to put on cables or bus-bars. In case of higher voltage levels the primary conductor must be insulated according to the rated insulation levels. The cast resin insulated indoor bushing-type current transformer can be used up to 1,2 kV. The current transformer is maintenance-free and mountable in any position.

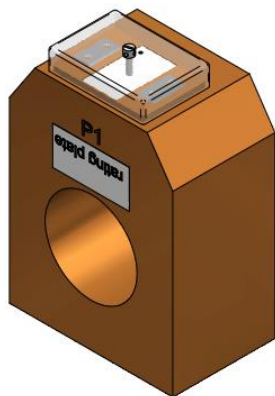

Ordering Specifications

For the customized design of your ELEQ GSA130 Current Transformer the following information is required:

Mandatory

- Rated primary current
- Rated secondary current
- Rated output
- Accuracy class
- Frequency

Optional

- Multi-core transformers are possible
- Terminal box sealable
- Other relevant requirements

Wiring diagram IEC 61869-2 e.g. single core

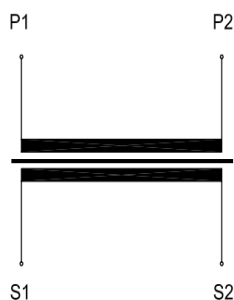

Technical specifications

| | |
|---|--|
| Environmental conditions | |
| This product is designed to be safe under the following conditions: | |
| Location: | Indoor use |
| Ambient air temperature: | -5°C .. +40°C; other temperatures on request |
| Storage and transport temperature: | -25°C .. +50°C |
| Relative humidity: | 5% .. 95%, non condensing |
| Altitude: | Max. 1000m above NN; at >1000m data required |
| Protection degree (secondary terminal): | IP20 |
| Application conditions | |
| Standard: | IEC 61869-2/IEEE C 57.13; etc. |
| IEC 61768-2 specification: | |
| Rated short-time thermal current (I _{th}): | 100 x I _n /1s, max. 100kA/1s, other duration on request |
| Rated dynamic current (I _{dyn}): | 2,5 x I _{th} |
| Continuous thermal current (I _{cth}): | up to 200% |
| Rated insulation level: | 1,2/6-kV |
| Rated frequency: | 50/60Hz |
| Class of insulation: | E |
| Rated primary current: | 30A - 1250A |
| Rated secondary current: | 1A or 5A; other options available on request |
| Rated output: | As required. For example 10VA, 15VA |
| Accuracy class: | As required. For example 0,2, 5P20 |
| Secondary terminal: | Screw terminals M5 (max. 2,5Nm) |

Dimensions

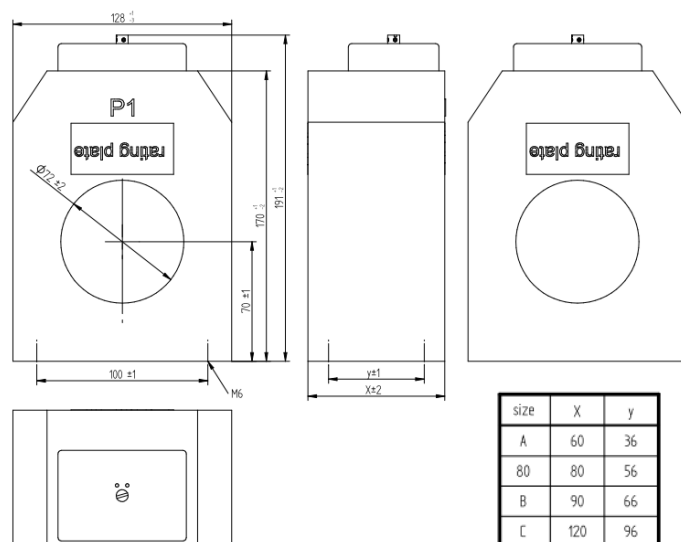

GSA135 – Bushing-type Current Transformer

The GSA135 is a cast-resin insulated bushing-type current transformer for indoor applications. They are suitable to put on cables or bus-bars. In case of higher voltage levels the primary conductor must be insulated according to the rated insulation levels. The cast resin insulated indoor bushing-type current transformer can be used up to 1,2 kV. The current transformer is maintenance-free and mountable in any position.

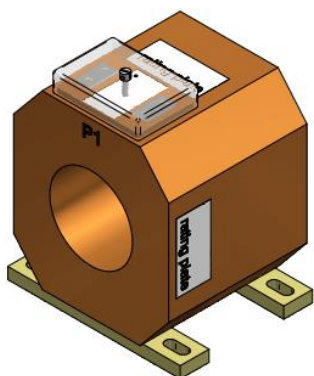

Ordering Specifications

For the customized design of your ELEQ GSA135 Current Transformer the following information is required:

Mandatory

- Rated primary current
- Rated secondary current
- Rated output
- Accuracy class
- Frequency

Optional

- Multi-core transformers are possible
- Terminal box sealable
- Other relevant requirements

Wiring diagram IEC 61869-2 e.g. single core

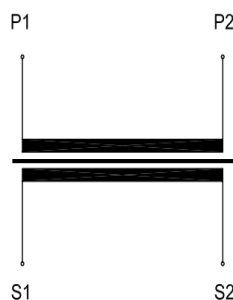

Technical specifications

| | |
|---|--|
| Environmental conditions | |
| This product is designed to be safe under the following conditions: | |
| Location: | Indoor use |
| Ambient air temperature: | -5°C .. +40°C; other temperatures on request |
| Storage and transport temperature: | -25°C .. +50°C |
| Relative humidity: | 5% .. 95%, non condensing |
| Altitude: | Max. 1000m above NN; at >1000m data required |
| Protection degree (secondary terminal): | IP20 |
| Application conditions | |
| Standard: | IEC 61869-2/IEEE C 57.13; etc. |
| IEC 61768-2 specification: | |
| Rated short-time thermal current (I _{th}): | 100 x I _n /1s, max. 100kA/1s, other duration on request |
| Rated dynamic current (I _{dyn}): | 2,5 x I _{th} |
| Continuous thermal current (I _{cth}): | up to 200% |
| Rated insulation level: | 1,2/6-kV |
| Rated frequency: | 50/60Hz |
| Class of insulation: | E |
| Rated primary current: | 30A - 1600A |
| Rated secondary current: | 1A or 5A; other options available on request |
| Rated output: | As required. For example 10VA, 15VA |
| Accuracy class: | As required. For example 0,2, 5P20 |
| Secondary terminal: | Screw terminals M5 (max. 2,5Nm) |

Dimensions

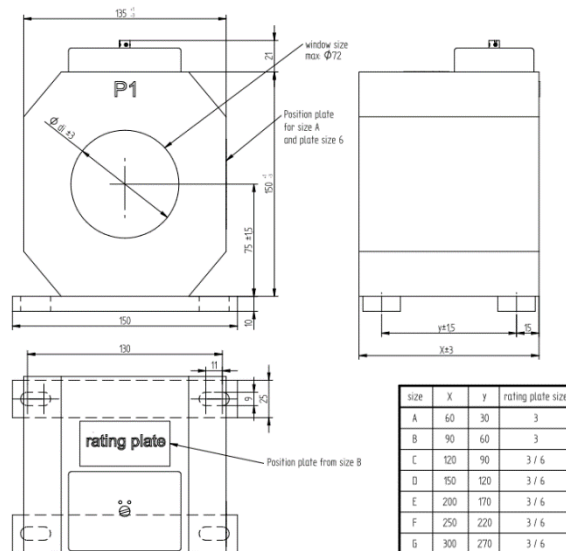

Ref. 1



GSA150 – Bushing-type Current Transformer

The GSA150 is a cast-resin insulated bushing-type current transformer for indoor applications. They are suitable to put on cables or bus-bars. In case of higher voltage levels the primary conductor must be insulated according to the rated insulation levels. The cast resin insulated indoor bushing-type current transformer can be used up to 1,2 kV. The current transformer is maintenance-free and mountable in any position.

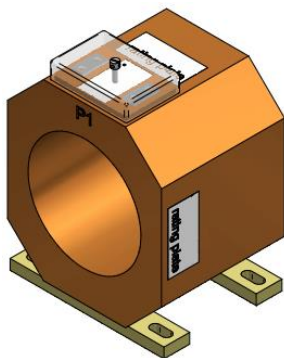

Ordering Specifications

For the customized design of your ELEQ GSA150 Current Transformer the following information is required:

Mandatory

- Rated primary current
- Rated secondary current
- Rated output
- Accuracy class
- Frequency

Optional

- Multi-core transformers are possible
- Terminal box sealable
- Other relevant requirements

Wiring diagram IEC 61869-2 e.g. single core

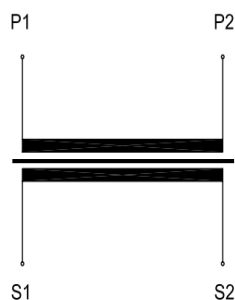

Technical specifications

| | |
|---|--|
| Environmental conditions | |
| This product is designed to be safe under the following conditions: | |
| Location: | Indoor use |
| Ambient air temperature: | -5°C .. +40°C; other temperatures on request |
| Storage and transport temperature: | -25°C .. +50°C |
| Relative humidity: | 5% .. 95%, non condensing |
| Altitude: | Max. 1000m above NN; at >1000m data required |
| Protection degree (secondary terminal): | IP20 |
| Application conditions | |
| Standard: | IEC 61869-2/IEEE C 57.13; etc. |
| IEC 61768-2 specification: | |
| Rated short-time thermal current (I _{th}): | 100 x I _n /1s, max. 100kA/1s, other duration on request |
| Rated dynamic current (I _{dyn}): | 2,5 x I _{th} |
| Continuous thermal current (I _{cth}): | up to 200% |
| Rated insulation level: | 1,2/6-kV |
| Rated frequency: | 50/60Hz |
| Class of insulation: | E |
| Rated primary current: | 30A - 2500A |
| Rated secondary current: | 1A or 5A; other options available on request |
| Rated output: | As required. For example 10VA, 15VA |
| Accuracy class: | As required. For example 0,2, 5P20 |
| Secondary terminal: | Screw terminals M5 (max. 2,5Nm) |

Dimensions

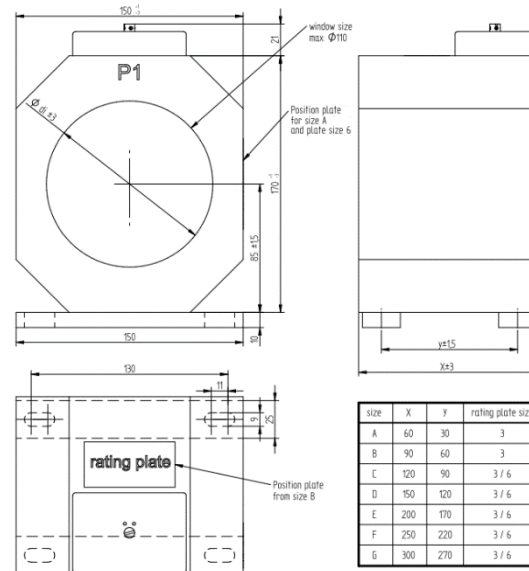

GSA170 – Bushing-type Current Transformer

The GSA170 is a cast-resin insulated bushing-type current transformer for indoor applications. They are suitable to put on cables or bus-bars. In case of higher voltage levels the primary conductor must be insulated according to the rated insulation levels. The cast resin insulated indoor bushing-type current transformer can be used up to 1,2 kV. The current transformer is maintenance-free and mountable in any position.

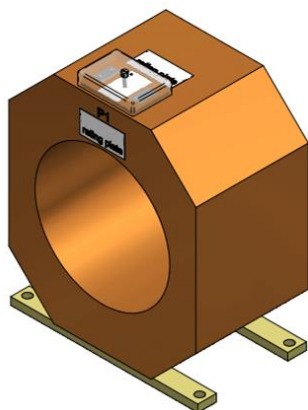

Ordering Specifications

For the customized design of your ELEQ GSA170 Current Transformer the following information is required:

Mandatory

- Rated primary current
- Rated secondary current
- Rated output
- Accuracy class
- Frequency

Optional

- Multi-core transformers are possible
- Terminal box sealable
- Earth-fault detection
- Other relevant requirements

Wiring diagram IEC 61869-2 e.g. single core

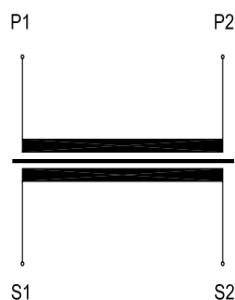

Technical specifications

| | |
|---|--|
| Environmental conditions | |
| This product is designed to be safe under the following conditions: | |
| Location: | Indoor use |
| Ambient air temperature: | -5°C .. +40°C; other temperatures on request |
| Storage and transport temperature: | -25°C .. +50°C |
| Relative humidity: | 5% .. 95%, non condensing |
| Altitude: | Max. 1000m above NN; at >1000m data required |
| Protection degree (secondary terminal): | IP20 |
| Application conditions | |
| Standard: | IEC 61869-2/IEEE C 57.13; etc. |
| IEC 61768-2 specification: | |
| Rated short-time thermal current (I _{th}): | 100 x I _n /1s, max. 100kA/1s, other duration on request |
| Rated dynamic current (I _{dyn}): | 2,5 x I _{th} |
| Continuous thermal current (I _{ct}): | up to 200% |
| Rated insulation level: | 1,2/6/-kV |
| Rated frequency: | 50/60Hz |
| Class of insulation: | E |
| Rated primary current: | 30A - 2000A |
| Rated secondary current: | 1A or 5A; other options available on request |
| Rated output: | As required. For example 10VA, 15VA |
| Accuracy class: | As required. For example 0,2, 5P20 |
| Secondary terminal: | Screw terminals M5 (max. 2,5Nm) |

Dimensions

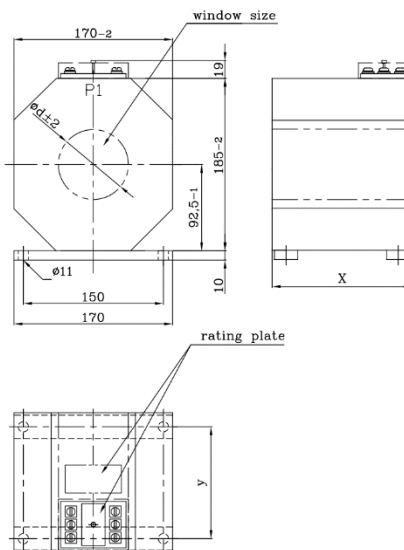

GSA200 – Bushing-type Current Transformer

The GSA200 is a cast-resin insulated bushing-type current transformer for indoor applications. They are suitable to put on cables or bus-bars. In case of higher voltage levels the primary conductor must be insulated according to the rated insulation levels. The cast resin insulated indoor bushing-type current transformer can be used up to 1,2 kV. The current transformer is maintenance-free and mountable in any position.

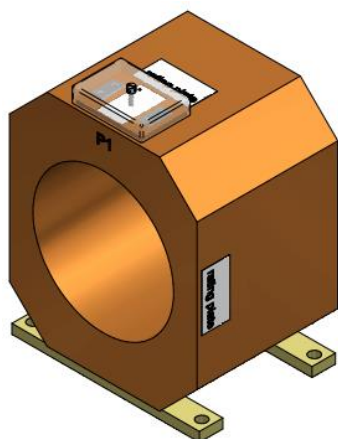

Ordering Specifications

For the customized design of your ELEQ GSA200 Current Transformer the following information is required:

Mandatory

- Rated primary current
- Rated secondary current
- Rated output
- Accuracy class
- Frequency

Optional

- Multi-core transformers are possible
- Terminal box sealable
- Earth-fault detection
- Other relevant requirements

Wiring diagram IEC 61869-2 e.g. single core

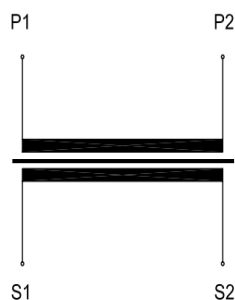

Technical specifications

Environmental conditions

This product is designed to be safe under the following conditions:

| | |
|------------------------------------|--|
| Location: | Indoor use |
| Ambient air temperature: | -5°C .. +40°C; other temperatures on request |
| Storage and transport temperature: | -25°C .. +50°C |
| Relative humidity: | 5% .. 95%, non condensing |
| Altitude: | Max. 1000m above NN; at >1000m data required |

Protection degree (secondary terminal):

IP20

Application conditions

| | |
|--|--|
| Standard: | IEC 61869-2/IEEE C 57.13; etc. |
| IEC 61768-2 specification: | |
| Rated short-time thermal current (I _{th}): | 100 x I _n /1s, max. 100kA/1s, other duration on request |
| Rated dynamic current (I _{dyn}): | 2,5 x I _{th} |
| Continuous thermal current (I _{cth}): | up to 200% |
| Rated insulation level: | 1,2/6-kV |
| Rated frequency: | 50/60Hz |
| Class of insulation: | E |
| Rated primary current: | 30A - 5000A |
| Rated secondary current: | 1A or 5A; other options available on request |
| Rated output: | As required. For example 10VA, 15VA |
| Accuracy class: | As required. For example 0,2, 5P20 |
| Secondary terminal: | Screw terminals M5 (max. 2,5Nm) |

Dimensions

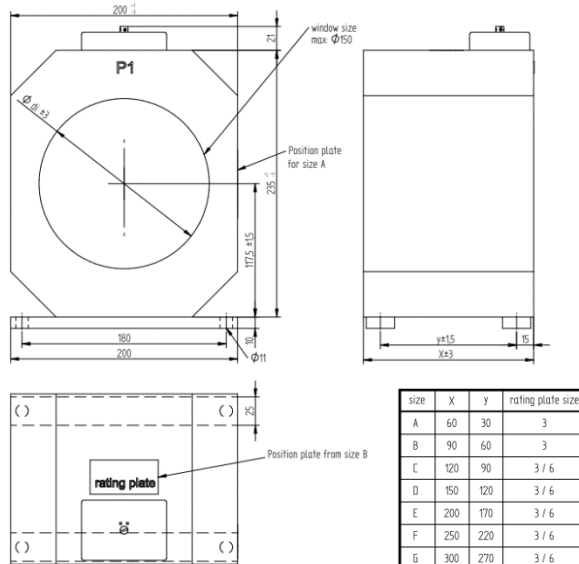

Ref. 1



GSA235 – Bushing-type Current Transformer

The GSA235 is a cast-resin insulated bushing-type current transformer for indoor applications. They are suitable to put on cables or bus-bars. In case of higher voltage levels the primary conductor must be insulated according to the rated insulation levels. The cast resin insulated indoor bushing-type current transformer can be used up to 1,2 kV. The current transformer is maintenance-free and mountable in any position.

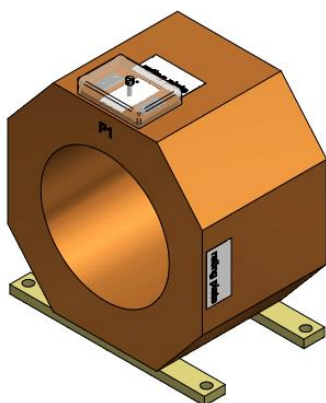

Ordering Specifications

For the customized design of your ELEQ GSA235 Current Transformer the following information is required:

Mandatory

- Rated primary current
- Rated secondary current
- Rated output
- Accuracy class
- Frequency

Optional

- Multi-core transformers are possible
- Terminal box sealable
- Earth-fault detection
- Other relevant requirements

Wiring diagram IEC 61869-2 e.g. single core

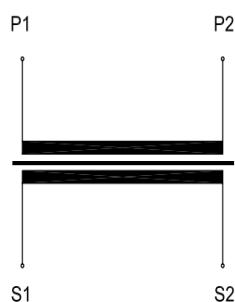

Technical specifications

| | |
|---|--|
| Environmental conditions | |
| This product is designed to be safe under the following conditions: | |
| Location: | Indoor use |
| Ambient air temperature: | -5°C .. +40°C; other temperatures on request |
| Storage and transport temperature: | -25°C .. +50°C |
| Relative humidity: | 5% .. 95%, non condensing |
| Altitude: | Max. 1000m above NN; at >1000m data required |
| Protection degree (secondary terminal): | IP20 |
| Application conditions | |
| Standard: | IEC 61869-2/IEEE C 57.13; etc. |
| IEC 61768-2 specification: | |
| Rated short-time thermal current (I _{th}): | 100 x I _n /1s, max. 100kA/1s, other duration on request |
| Rated dynamic current (I _{dyn}): | 2,5 x I _{th} |
| Continuous thermal current (I _{cth}): | up to 200% |
| Rated insulation level: | 1,2/6-kV |
| Rated frequency: | 50/60Hz |
| Class of insulation: | E |
| Rated primary current: | 30A - 5000A |
| Rated secondary current: | 1A or 5A; other options available on request |
| Rated output: | As required. For example 10VA, 15VA |
| Accuracy class: | As required. For example 0,2, 5P20 |
| Secondary terminal: | Screw terminals M5 (max. 2,5Nm) |

Dimensions

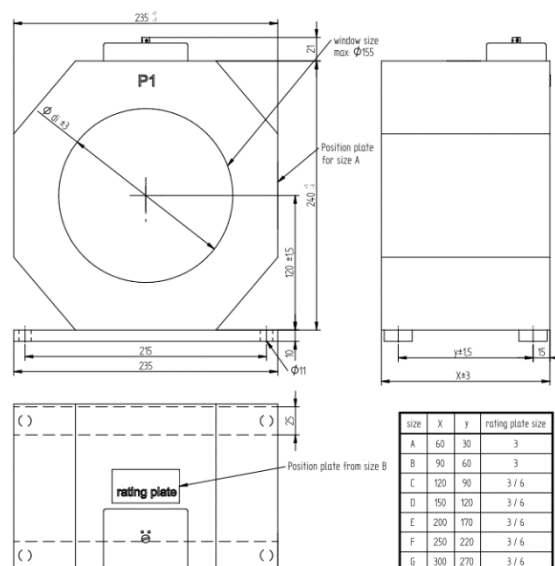

Ref. 1



GSA250 – Bushing-type Current Transformer

The GSA250 is a cast-resin insulated bushing-type current transformer for indoor applications. They are suitable to put on cables or bus-bars. In case of higher voltage levels the primary conductor must be insulated according to the rated insulation levels. The cast resin insulated indoor bushing-type current transformer can be used up to 1,2 kV. The current transformer is maintenance-free and mountable in any position.

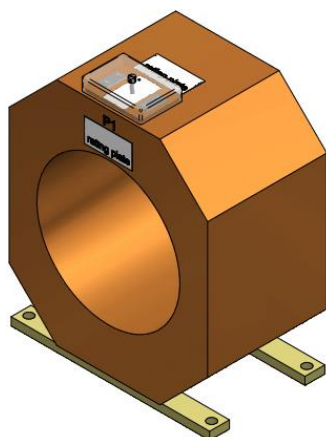

Ordering Specifications

For the customized design of your ELEQ GSA250 Current Transformer the following information is required:

Mandatory

- Rated primary current
- Rated secondary current
- Rated output
- Accuracy class
- Frequency

Optional

- Multi-core transformers are possible
- Terminal box sealable
- Earth-fault detection
- Other relevant requirements

Wiring diagram IEC 61869-2 e.g. single core

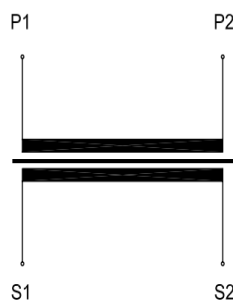

Technical specifications

Environmental conditions

This product is designed to be safe under the following conditions:

| | |
|---|--|
| Location: | Indoor use |
| Ambient air temperature: | -5°C .. +40°C; other temperatures on request |
| Storage and transport temperature: | -25°C .. +50°C |
| Relative humidity: | 5% .. 95%, non condensing |
| Altitude: | Max. 1000m above NN; at >1000m data required |
| Protection degree (secondary terminal): | IP20 |

Application conditions

| | |
|--|--|
| Standard: | IEC 61869-2/IEEE C 57.13; etc. |
| IEC 61768-2 specification: | |
| Rated short-time thermal current (I _{th}): | 100 x I _n /1s, max. 100kA/1s, other duration on request |
| Rated dynamic current (I _{dyn}): | 2,5 x I _{th} |
| Continuous thermal current (I _{cth}): | up to 200% |
| Rated insulation level: | 1,2/6-kV |
| Rated frequency: | 50/60Hz |
| Class of insulation: | E |
| Rated primary current: | 30A - 6000A |
| Rated secondary current: | 1A or 5A; other options available on request |
| Rated output: | As required. For example 10VA, 15VA |
| Accuracy class: | As required. For example 0,2, 5P20 |
| Secondary terminal: | Screw terminals M5 (max. 2,5Nm) |

Dimensions

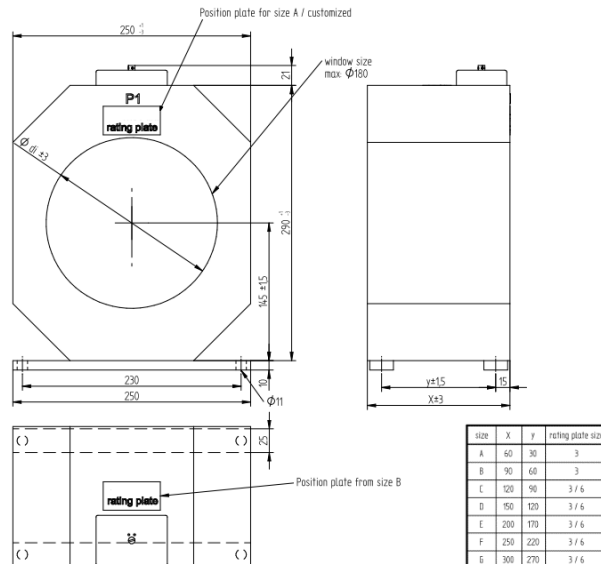

Ref. 1



GSA300 – Bushing-type Current Transformer

The GSA300 is a cast-resin insulated bushing-type current transformer for indoor applications. They are suitable to put on cables or bus-bars. In case of higher voltage levels the primary conductor must be insulated according to the rated insulation levels. The cast resin insulated indoor bushing-type current transformer can be used up to 1,2 kV. The current transformer is maintenance-free and mountable in any position.

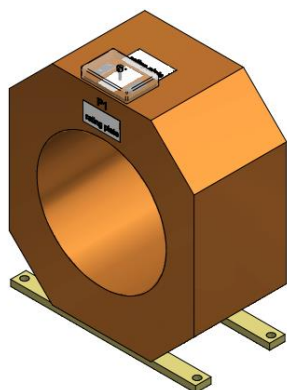

Ordering Specifications

For the customized design of your ELEQ GSA300 Current Transformer the following information is required:

Mandatory

- Rated primary current
- Rated secondary current
- Rated output
- Accuracy class
- Frequency

Optional

- Multi-core transformers are possible
- Terminal box sealable
- Earth-fault detection
- Other relevant requirements

Wiring diagram IEC 61869-2 e.g. single core

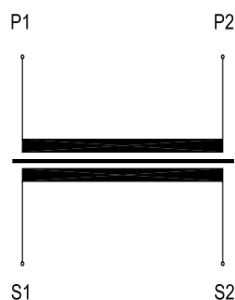

Technical specifications

| | |
|---|--|
| Environmental conditions | |
| This product is designed to be safe under the following conditions: | |
| Location: | Indoor use |
| Ambient air temperature: | -5°C .. +40°C; other temperatures on request |
| Storage and transport temperature: | -25°C .. +50°C |
| Relative humidity: | 5% .. 95%, non condensing |
| Altitude: | Max. 1000m above NN; at >1000m data required |
| Protection degree (secondary terminal): | IP20 |
| Application conditions | |
| Standard: | IEC 61869-2/IEEE C 57.13; etc. |
| IEC 61768-2 specification: | |
| Rated short-time thermal current (I _{th}): | 100 x I _n /1s, max. 100kA/1s, other duration on request |
| Rated dynamic current (I _{dyn}): | 2,5 x I _{th} |
| Continuous thermal current (I _{cth}): | up to 200% |
| Rated insulation level: | 1,2/6/-kV |
| Rated frequency: | 50/60Hz |
| Class of insulation: | E |
| Rated primary current: | 30A – 10.000A |
| Rated secondary current: | 1A or 5A; other options available on request |
| Rated output: | As required. For example 10VA, 15VA |
| Accuracy class: | As required. For example 0,2, 5P20 |
| Secondary terminal: | Screw terminals M5 (max. 2,5Nm) |

Dimensions

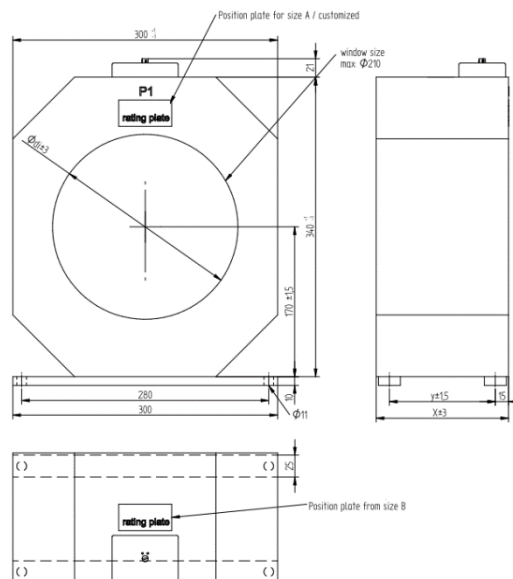

Ref. 1



GSA350 – Bushing-type Current Transformer

The GSA350 is a cast-resin insulated bushing-type current transformer for indoor applications. They are suitable to put on cables or bus-bars. In case of higher voltage levels the primary conductor must be insulated according to the rated insulation levels. The cast resin insulated indoor bushing-type current transformer can be used up to 1,2 kV. The current transformer is maintenance-free and mountable in any position.

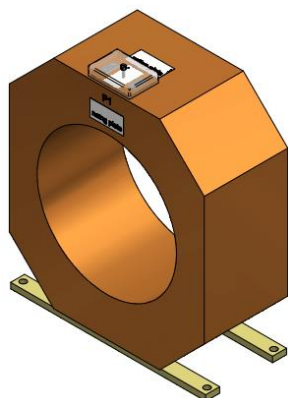

Ordering Specifications

For the customized design of your ELEQ GSA350 Current Transformer the following information is required:

Mandatory

- Rated primary current
- Rated secondary current
- Rated output
- Accuracy class
- Frequency

Optional

- Multi-core transformers are possible
- Terminal box sealable
- Earth-fault detection
- Other relevant requirements

Wiring diagram IEC 61869-2 e.g. single core

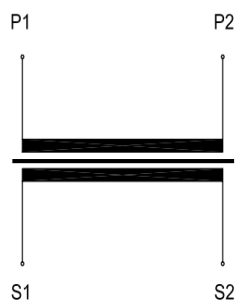

Technical specifications

| | |
|---|--|
| Environmental conditions | |
| This product is designed to be safe under the following conditions: | |
| Location: | Indoor use |
| Ambient air temperature: | -5°C .. +40°C; other temperatures on request |
| Storage and transport temperature: | -25°C .. +50°C |
| Relative humidity: | 5% .. 95%, non condensing |
| Altitude: | Max. 1000m above NN; at >1000m data required |
| Protection degree (secondary terminal): | IP20 |
| Application conditions | |
| Standard: | IEC 61869-2/IEEE C 57.13; etc. |
| IEC 61768-2 specification: | |
| Rated short-time thermal current (I _{th}): | 100 x I _n /1s, max. 100kA/1s, other duration on request |
| Rated dynamic current (I _{dyn}): | 2,5 x I _{th} |
| Continuous thermal current (I _{cth}): | up to 200% |
| Rated insulation level: | 1,2/6/-kV |
| Rated frequency: | 50/60Hz |
| Class of insulation: | E |
| Rated primary current: | 30A – 10.000A |
| Rated secondary current: | 1A or 5A; other options available on request |
| Rated output: | As required. For example 10VA, 15VA |
| Accuracy class: | As required. For example 0,2, 5P20 |
| Secondary terminal: | Screw terminals M5 (max. 2,5Nm) |

Dimensions

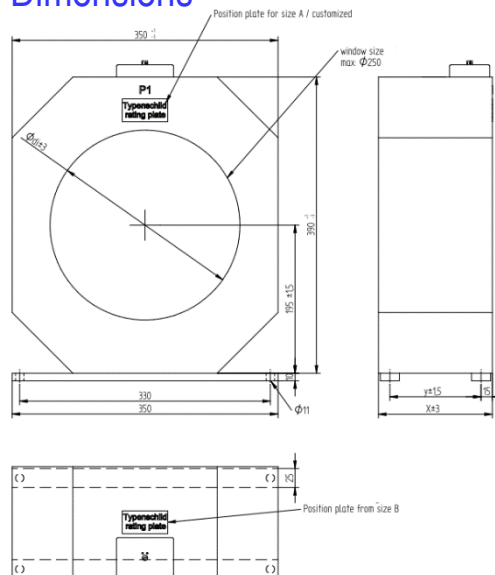

Ref. 1



GSA400 – Bushing-type Current Transformer

The GSA400 is a cast-resin insulated bushing-type current transformer for indoor applications. They are suitable to put on cables or bus-bars. In case of higher voltage levels the primary conductor must be insulated according to the rated insulation levels. The cast resin insulated indoor bushing-type current transformer can be used up to 1,2 kV. The current transformer is maintenance-free and mountable in any position.

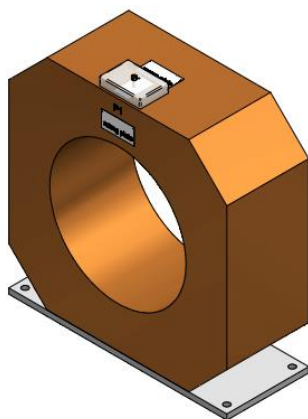

Ordering Specifications

For the customized design of your ELEQ GSA400 Current Transformer the following information is required:

Mandatory

- Rated primary current
- Rated secondary current
- Rated output
- Accuracy class
- Frequency

Optional

- Multi-core transformers are possible
- Terminal box sealable
- Earth-fault detection
- Other relevant requirements

Wiring diagram IEC 61869-2 e.g. single core

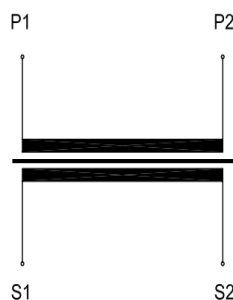

Technical specifications

| | |
|---|--|
| Environmental conditions | |
| This product is designed to be safe under the following conditions: | |
| Location: | Indoor use |
| Ambient air temperature: | -5°C .. +40°C; other temperatures on request |
| Storage and transport temperature: | -25°C .. +50°C |
| Relative humidity: | 5% .. 95%, non condensing |
| Altitude: | Max. 1000m above NN; at >1000m data required |
| Protection degree (secondary terminal): | IP20 |
| Application conditions | |
| Standard: | IEC 61869-2/IEEE C 57.13; etc. |
| IEC 61768-2 specification: | |
| Rated short-time thermal current (I _{th}): | 100 x I _n /1s, max. 100kA/1s, other duration on request |
| Rated dynamic current (I _{dyn}): | 2,5 x I _{th} |
| Continuous thermal current (I _{cth}): | up to 200% |
| Rated insulation level: | 1,2/6-kV |
| Rated frequency: | 50/60Hz |
| Class of insulation: | E |
| Rated primary current: | 30A – 10.000A |
| Rated secondary current: | 1A or 5A; other options available on request |
| Rated output: | As required. For example 10VA, 15VA |
| Accuracy class: | As required. For example 0,2, 5P20 |
| Secondary terminal: | Screw terminals M5 (max. 2,5Nm) |

Dimensions

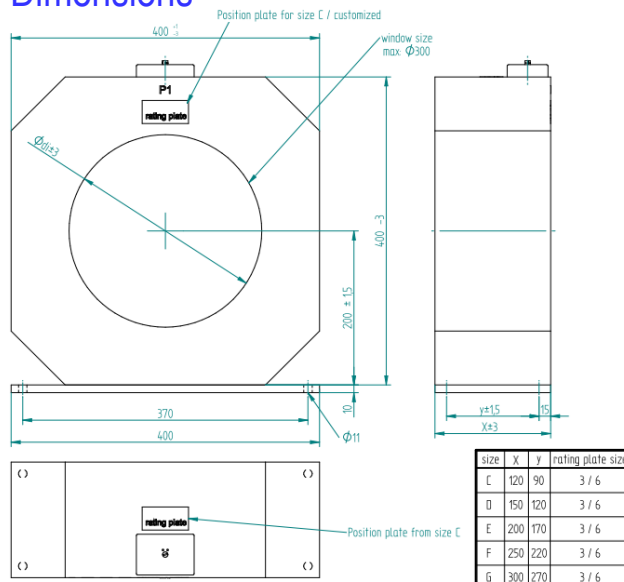

GSA500 – Bushing-type Current Transformer

The GSA500 is a cast-resin insulated bushing-type current transformer for indoor applications. They are suitable to put on cables or bus-bars. In case of higher voltage levels the primary conductor must be insulated according to the rated insulation levels. The cast resin insulated indoor bushing-type current transformer can be used up to 1,2 kV. The current transformer is maintenance-free and mountable in any position.

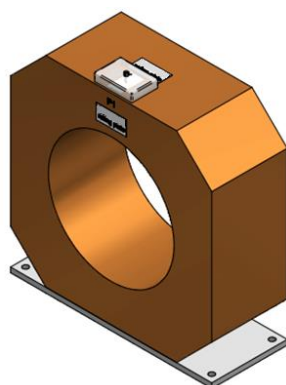

Ordering Specifications

For the customized design of your ELEQ GSA500 Current Transformer the following information is required:

Mandatory

- Rated primary current
- Rated secondary current
- Rated output
- Accuracy class
- Frequency

Optional

- Multi-core transformers are possible
- Terminal box sealable
- Earth-fault detection
- Other relevant requirements

Wiring diagram IEC 61869-2 e.g. single core

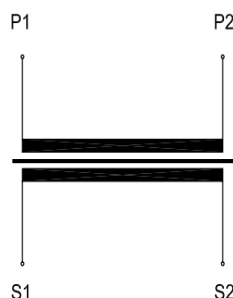

Technical specifications

| | |
|---|--|
| Environmental conditions | |
| This product is designed to be safe under the following conditions: | |
| Location: | Indoor use |
| Ambient air temperature: | -5°C .. +40°C; other temperatures on request |
| Storage and transport temperature: | -25°C .. +50°C |
| Relative humidity: | 5% .. 95%, non condensing |
| Altitude: | Max. 1000m above NN; at >1000m data required |
| Protection degree (secondary terminal): | IP20 |
| Application conditions | |
| Standard: | IEC 61869-2/IEEE C 57.13; etc. |
| IEC 61768-2 specification: | |
| Rated short-time thermal current (I _{th}): | 100 x I _n /1s, max. 100kA/1s, other duration on request |
| Rated dynamic current (I _{dyn}): | 2,5 x I _{th} |
| Continuous thermal current (I _{cth}): | up to 200% |
| Rated insulation level: | 1,2/6-kV |
| Rated frequency: | 50/60Hz |
| Class of insulation: | E |
| Rated primary current: | 30A – 15.000A |
| Rated secondary current: | 1A or 5A; other options available on request |
| Rated output: | As required. For example 10VA, 15VA |
| Accuracy class: | As required. For example 0,2, 5P20 |
| Secondary terminal: | Screw terminals M5 (max. 2,5Nm) |

Dimensions

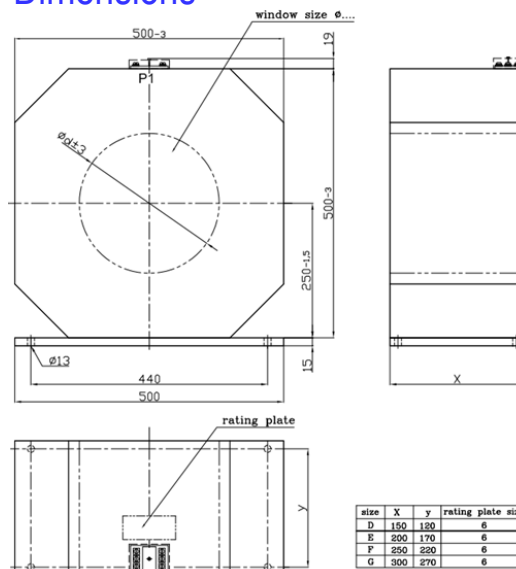

Ref. 1

